

THE INFORMATION CONTAINED IN THIS LEAFLET/PLAN/DRAWING IS INDICATIVE OF DEVELOPMENT THAT IS PROPOSED SUBJECT TO APPROVAL OF THE AUTHORITIES OR IN THE INTEREST OF CONTINUING IMPROVEMENT. THE ARCHITECT/DEVELOPER RESERVE THE RIGHT TO CHANGE THE PLAN.

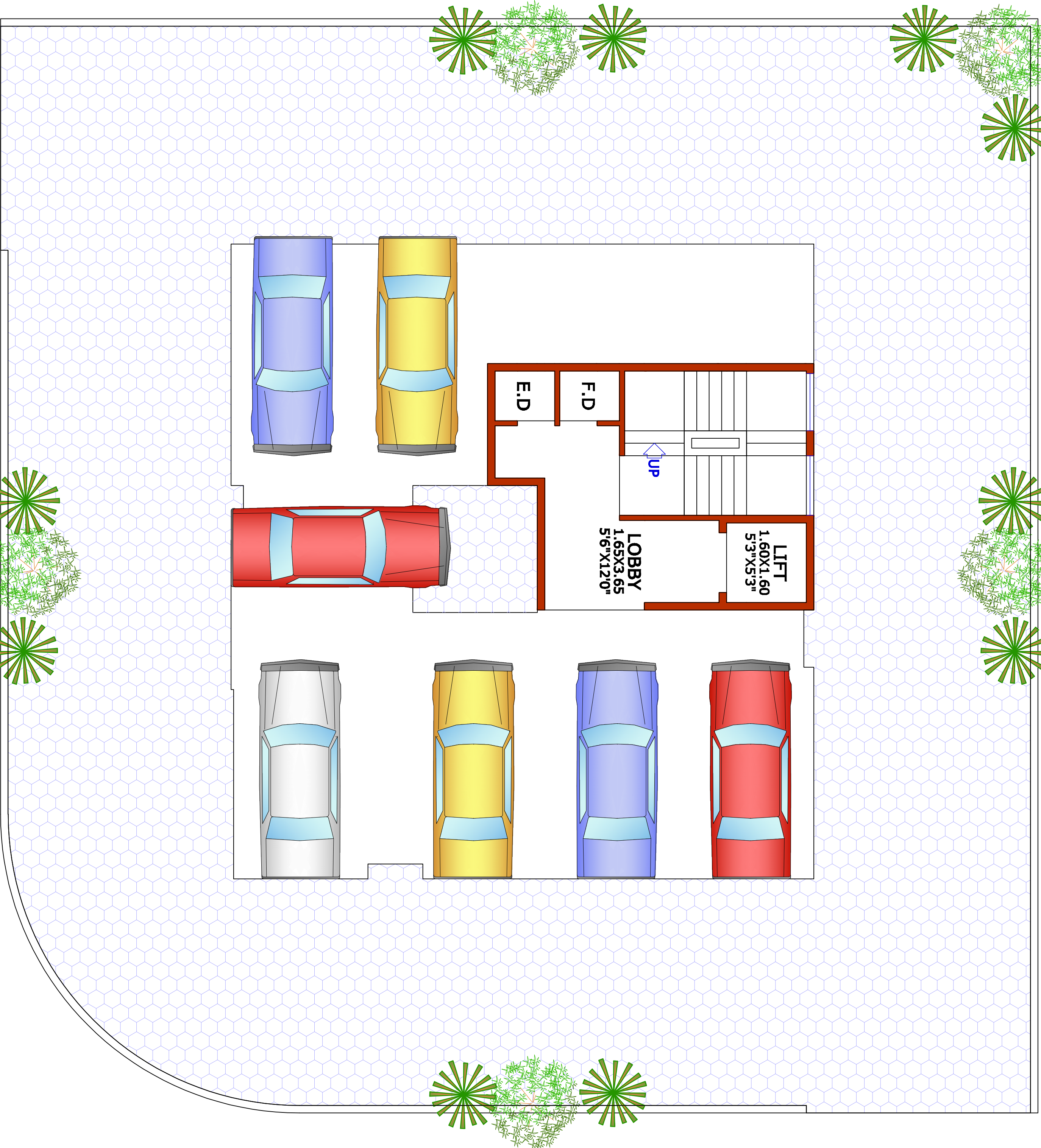

11.00 M. WIDE ROAD

9.00 M. WIDE ROAD

PROJECT

PROPOSED RESIDENTIAL
BUILDING ON PLOT NO.- 35,
SECTOR-54, DRONAGIRI,
NAVI MUMBAI.

DEVELOPERS

NORTH

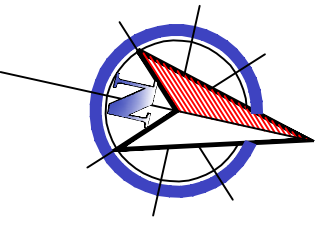

FLOOR

GROUND FLOOR PLAN

ARCHITECTS



TRIARCH DESIGN STUDIO
ARCHITECTS AND INTERIOR DESIGNERS
HEAD OFF : BHAGAVATI BHUVAN, SARASWATI BAUG, JOGESHWARI (E),
MUMBAI 400 080. TEL: 28384441.
BRANCH OFF : 18, GAUR COMMERICAL COMPLEX, PLOT NO 18, SECTOR 11,
C.B.D., BELAPUR, NAVI MUMBAI. TEL: 27980810, 27988887.